

GROUND FLOOR, 65 CHANDOS PLACE COVENT GARDEN, WC2 2,097 SQ FT MODERN OFFICE FLOOR TO LET



LOCATION

Chandos Place sits in the heart of Covent Garden, just a few minutes walk from the Piazza with a host of shops, bars, restaurants and theatres close by. Public transport is excellent with easy access to Charing Cross, Covent Garden, Leicester Square and Embankment stations (District, Circle, Bakerloo, Northern and Piccadilly underground lines plus Mainline services from Charing Cross).

DESCRIPTION

The accommodation comprises the part ground floor which provides bright, modern office space arranged mainly in open plan plus boardroom and kitchen/storage areas. It has a net internal floor area of 2,097 sq ft.

AMENITIES

- Attractive manned reception lobby
- 4 pipe Air conditioning
- Full access raised floor
- Suspended ceiling with inset lighting
- Passenger lift
- Full "Plug and Play" option available
- Fibre and network cabling installed
- Furniture available by arrangement
- Very good natural light

LEASE

The premises are available either:

- on a Sublease until May 2019 or
- a new longer term lease direct from the landlord.



RENT AND OUTGOINGS

Rent:	£62.50 per sq ft
Rates:	c.£30.00 per sq ft
Service Charge:	c.£15.00 per sq ft (inc insurance)

VIEWINGS

Graham Rossall

☎ 020 7297 9663 / 07712 779621

✉ g.rossall@hmc.london

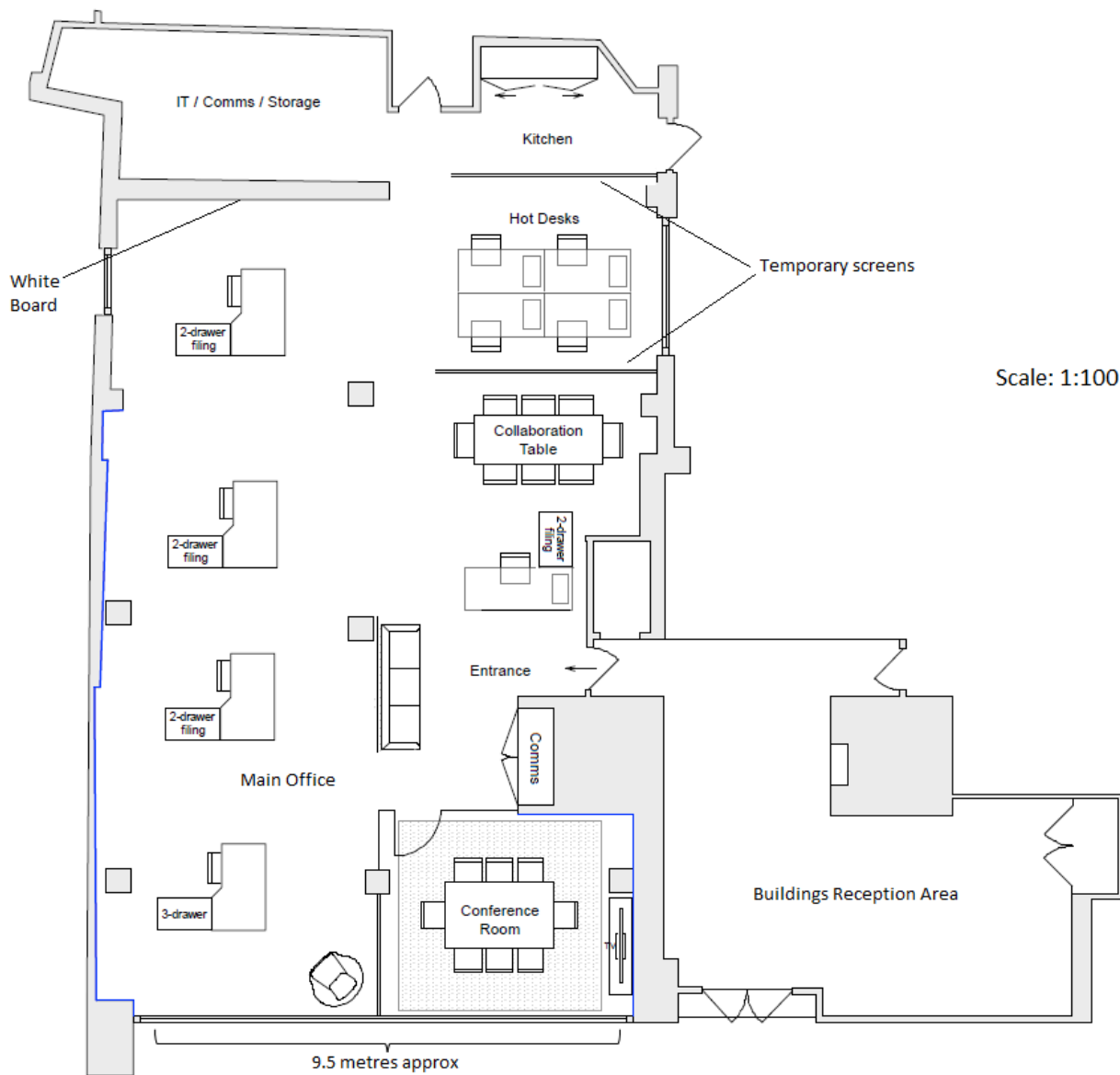

EXISTING LAYOUT